

New item! Adjust the nut with just one touch!

Free adjustment nut M16 ^{NEW}

Problem

The rod is so big.
This is taking too long!

I wish there was a
faster way.

I hate this!

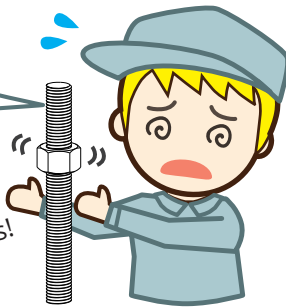

Solution!

With **Free Adjustment Nut**,
I can install and remove
the nut with just one touch!
It's so much faster and
easier!

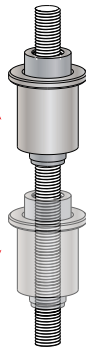

Wow! So much easier!



■ **So easy, anyone can do it**

■ **With a maximum load of 6800N, Free Adjustment Nut can be used for heavy duty jobs** (Note: this calculation was determined by internal research. Details on back)

■ **Safety marking lets you verify safety at a glance**

How to use

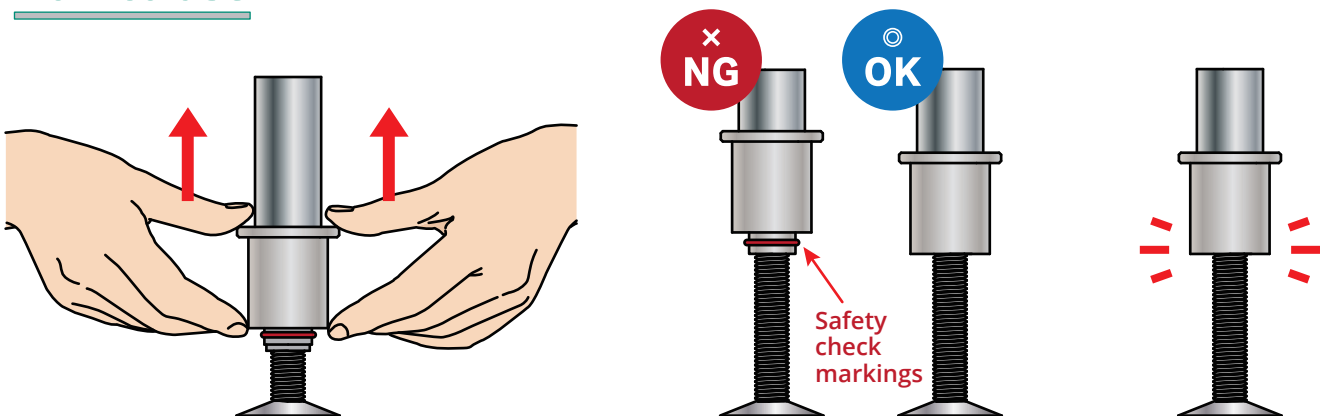

Pull up the exterior brim and move to the
desired point.

When released, the outer part snaps back into
place. Then verify that the Safety Check
Marking is hidden.

Finished!!

Ohsato Co. Ltd. Space Creation-Product (SCP) Division
7-4-4 Minami-ku Uchiya Saitama-city Saitama 336-0034 Japan

TEL:+81 48 863 6411 FAX:+81 48 863 8459

OHSATO

<https://ohsato-web.co.jp/>

In order to improve our products, changes may be
made to the design (color, length/weight, price,
etc) without prior announcement. Product color
may differ slightly from the photos in the flyer.

Our new technology makes your life easier!

Free adjustment nut M16

Strength test

Equipment	Strength evaluation tester
Manufacturer	SHIMADZU CORPORATION
Model No.	AG-250KNI
Method of testing FA nut	1. 8 total units were tested. 4 units had previously been tested 1000 times. ①～④ The remaining 4 units were new. ⑤～⑧ 2. Test was performed by gradually increasing load and verifying proper function regularly until breakage.

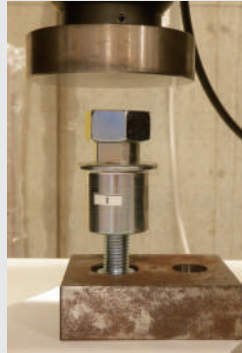

Conclusion

Operation was performed with a minimum load of 3.5t and maximum load of 4.5t. Inspections were made every 0.3t until pieces failed. As a result, allowable load is set as 1/5 of minimum load value (3.5t) which is 6800N.

Test piece		①	②	③	④	⑤	⑥	⑦	⑧
3.5t	○	○	○	○	○	○	○	○	○
3.9t	×	○	○	○	○	○	○	○	○
4.2t		×	○	○	○	○	○	○	○
4.5t			×	×	○	×	×	×	○
4.8t					×				×

Examples

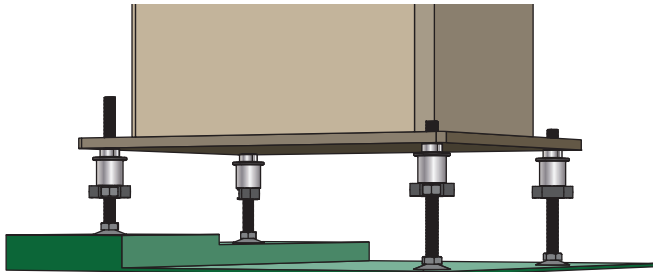

It can be used to level small to medium-sized processing equipment, amusement equipment, other industrial equipment, tables, work tables, and other places with level differences

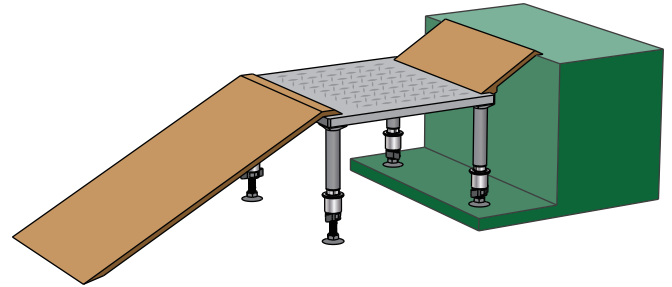

For setting a slope at work sites, temporary site, and event spaces

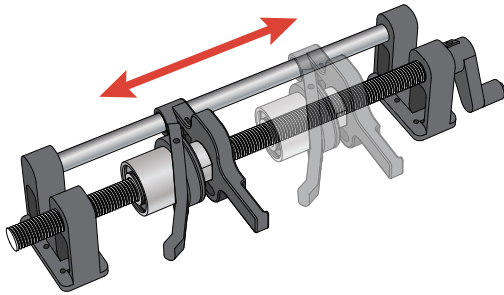

By using a feed screw, you can freely adjust the slide to any location and make fine adjustments with the screw (This product does not support precision screws such as trapezoidal threads)

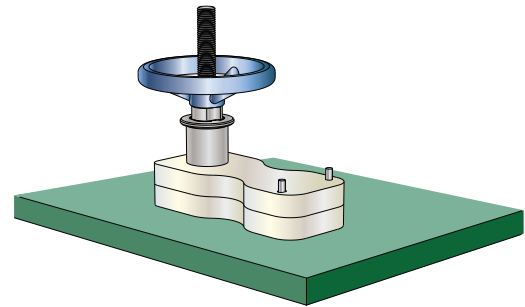

Easily install or uninstall jig covers that are frequently removed

Specifications

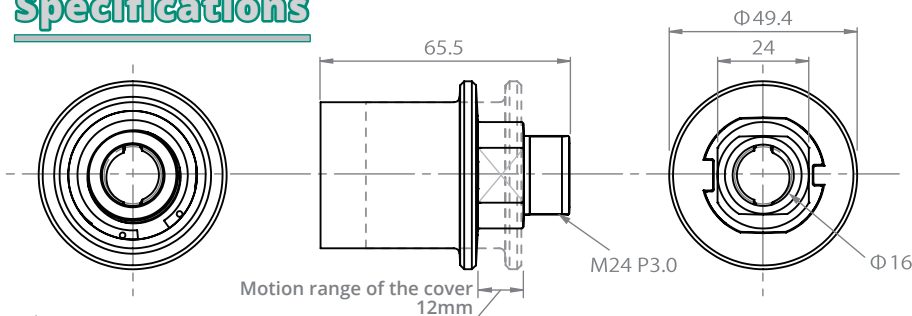

Caution

Note: FA Nut=Free adjustment nut

- If you build into a frame, you need M24P3.0 internal thread machining in the frame side (Valid thread diameter is more than 15mm)
- It is possible to tighten by spanner when putting FA Nut to the frame. (Spanner diameter is 24mm, maximum tightening torque is 85N·m)
- Make sure red marking is completely hidden
- Do not use in over allowable loads such as applying a strong shock to FA Nut. • Avoid pulling up the cover while a load is applied
- Please tighten the FA Nut by double nut if you use it as an adjuster
- Minimum penetration of 65.5mm is required. Internal diameter= 16mm

Note: FA Nut=Free adjustment nut

Parts	Material
FA Nut core part	Zinc die casting
FA Nut cover	Zinc die casting
FA Nut split nut	Zinc die casting
Spring pressure plate	Steel / Unichrome
Compression spring L	Stainless steel
Compression spring S	Stainless steel
Round R type snap ring	Steel
O-ring	Silicon

powered by YouTube



[Check the video](#)

OHSATO